

Katalog

upevňovacího
systému **1/2016**
pro elektromontáže
a datové instalace



www.schmachtl.cz

OBSAH

Natloukáací příchytka
 Šrouboací příchytka
 Příchytka pro podhledové profily
 Řetízky a háky
 Trapézové příchytka
 Nerezový pásek
 Závrtové tyče
 Natloukáací hmoždinky

Strana 3-7
 Strana 8-9
 Strana 10
 Strana 11
 Strana 12
 Strana 13
 Strana 14
 Strana 14

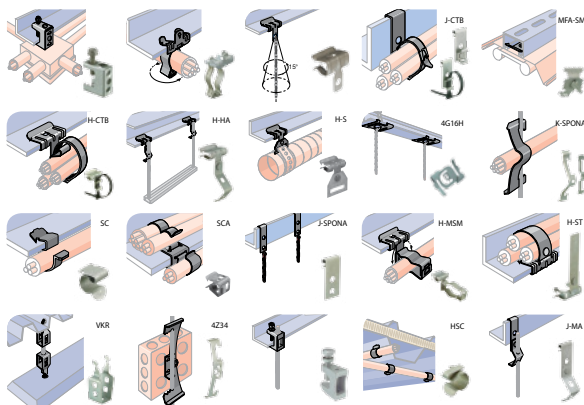

„Široký sortiment příchytěk a upevňovacích systémů pro použití v elektroinstalaci“



Poznámky

Blank lined area for notes, consisting of 12 horizontal grey bars.

H-PŘÍCHYTKA

	Obj.č.	A mm		Kus		
				kg/NS	Kč	kg
P4						
2H4	170010	2-3	100	70	15,00	0,013
4H24	170020	3-8	100	90	16,50	0,013
4H58	170030	8-14	100	90	18,00	0,015
4H912	170040	14-20	100	90	19,50	0,018
P4 - EPZ						
4H24 - 25	172320	3-8	10 x 25	90	16,50	0,013
4H58 - 25	172350	8-14	10 x 25	90	18,00	0,014
4H912 - 25	172380	14-20	10 x 25	90	19,50	0,016

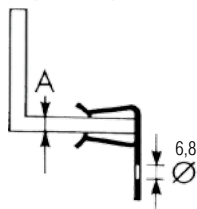

H-I-PŘÍCHYTKA

	Obj.č.	A mm		Kus		
				kg/NS	Kč	kg
P4						
4H24i	170150	3-8	100	15	20,80	0,015
4H58i	170250	8-14	100	15	22,30	0,017

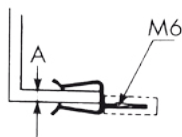
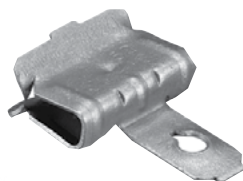

H-IX-PŘÍCHYTKA

	Obj.č.	A mm		Kus		
				kg/NS	Kč	kg
P4 - EPZ						
4H24iX	170140	3-8	100	15	42,50	0,015
4H58iX	170160	8-14	100	15	44,00	0,017

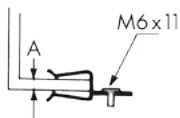

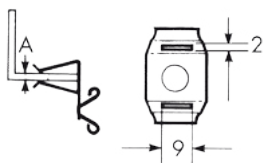

Obj.č.	A mm	Kus	Kus			
			kg/NS	Kč	kg	
P4 - EPZ						
2H4CT	178510	2-3	100	15	40,00	0,010
4H24CT	178520	3-8	100	15	42,50	0,018
4H58CT	178530	8-14	100	15	44,00	0,020
4H912CT	178540	14-20	100	15	45,50	0,022
4H24CT - 25	172330	3-8	10 x 25	15	42,50	0,018
4H58CT - 25	172360	8-14	10 x 25	15	44,00	0,020
4H912CT - 25	172390	14-20	10 x 25	15	45,50	0,022

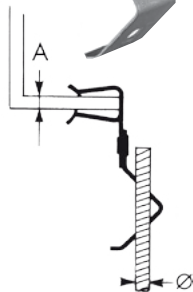

H-MA PŘÍCHYTKA

Obj.č.	A mm	Ø	Kus	Kus			
				kg/NS	Kč	kg	
P4 - EPZ							
M6MA4	173230	2-3	M6	100	60	47,40	0,025
M6MA24	173240	3-8	M6	100	60	48,90	0,025
M6MA58	173250	8-14	M6	100	60	50,40	0,027
M6MA912	173260	14-20	M6	100	60	52,60	0,030
M8MA4	173270	2-3	M8	100	70	47,40	0,025
M8MA24	173280	3-8	M8	100	70	47,40	0,025
M8MA58	173290	8-14	M8	100	70	48,90	0,027
M8MA912	173300	14-20	M8	100	70	52,60	0,030
M10MA4	173310	2-3	M10	100	70	47,40	0,025
M10MA24	173320	3-8	M10	100	70	48,90	0,025
M10MA58	173330	8-14	M10	100	70	50,40	0,027
M10MA912	173340	14-20	M10	100	70	52,60	0,030

EM-PŘÍCHYTKA

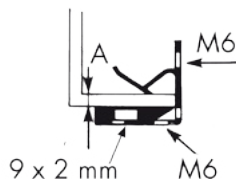
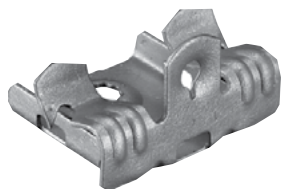

	Obj.č.	A mm		Kus		
				kg/NS	Kč	kg
P4 - EPZ						
EM24	170050	3-8	100	45	22,50	0,028
EM58	170060	8-14	100	45	24,80	0,031
EM912	170070	14-20	100	45	27,10	0,035
EM24 - 25	172170	3-8	10 x 25	45	22,50	0,028
EM58 - 25	172180	8-14	10 x 25	45	24,80	0,031
EM912 - 25	175760	14-20	10 x 25	45	27,10	0,035



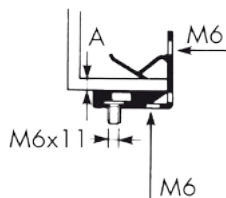
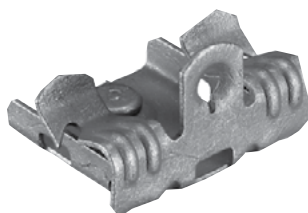

EM-SM PŘÍCHYTKA

	Obj.č.	A mm		Kus		
				kg/NS	Kč	kg
P4 - EPZ						
EM24SM	170530	3-8	100	33	36,00	0,028
EM58SM	172060	8-14	100	33	38,70	0,032
EM912SM	171850	14-20	100	33	43,00	0,038
EM24SM16-10	172220	3-8	10 x 10	33	54,90	0,038
EM58SM16-10	172230	8-14	10 x 10	33	59,10	0,041
EM912SM16-10	172240	14-20	10 x 10	33	59,10	0,045



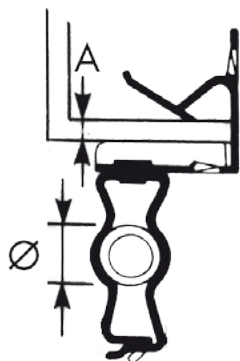

	Obj.č.	A mm	Ø		Kus		
					kg/NS	Kč	kg
P4 - EPZ							
6EM24	173550	3-8	14-18	100	33	57,10	0,035
6EM58	171750	8-14	14-18	100	33	61,60	0,039
6EM912	173560	14-20	14-18	50	33	60,90	0,044
812EM24	160120	3-8	18-30	50	33	60,90	0,036
812EM58	160130	8-14	18-30	50	33	67,70	0,041
812EM912	160140	14-20	18-30	50	33	70,60	0,046
16EM24	171740	3-8	30-35	50	33	56,40	0,040
16EM58	171490	8-14	30-35	50	33	58,30	0,043
16EM912	173570	14-20	30-35	50	33	78,20	0,049
20EM24	171800	3-8	35-42	50	33	67,70	0,042
20EM58	171950	8-14	35-42	50	33	69,40	0,047
20EM912	173580	14-20	35-42	50	33	90,20	0,052
24EM24	171960	3-8	42-50	50	33	94,70	0,044
24EM58	171970	8-14	42-50	50	33	98,50	0,047
24EM912	173590	14-20	42-50	50	33	103,70	0,053
32EM24	173600	3-8	50-60	50	33	105,20	0,048
32EM58	173610	8-14	50-60	50	33	111,20	0,052
32EM912	173620	14-20	50-60	50	33	116,50	0,060



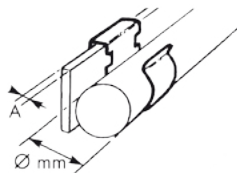

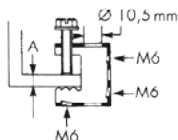
	Obj.č.	A mm	Ø		Kus	
					Kč	kg
P1(P4)						
24SC67	187510	2-4	6-7	100	4,50	0,004
24SC78	187710	2-4	7-8	100	4,50	0,004
24SC89	187530	2-4	8-9	100	4,50	0,004
24SC910	187750	2-4	9-10	100	4,50	0,004
24SC1011	187550	2-4	10-11	100	4,60	0,005
24SC1214	187570	2-4	12-14	100	4,60	0,005
24SC1518	187590	2-4	15-18	100	5,30	0,006
24SC1924	187610	2-4	19-24	100	6,90	0,007
24SC2530	187630	2-4	25-32	100	8,30	0,008
P1(P4)						
47SC67	187500	4-7	6-7	100	4,50	0,004
47SC78	187720	4-7	7-8	100	4,50	0,004
47SC89	187520	4-7	8-9	100	4,50	0,004
47SC910	187760	4-7	9-10	100	4,50	0,004
47SC1011	187540	4-7	10-11	100	4,60	0,005
47SC1214	187560	4-7	12-14	100	4,60	0,005
47SC1518	187580	4-7	15-18	100	5,30	0,006
47SC1924	187600	4-7	19-24	100	6,90	0,007
47SC2530	187620	4-7	25-32	100	8,30	0,008
P1(P4)						
812SC67	187640	8-12	6-7	100	4,50	0,005
812SC78	187730	8-12	7-8	100	4,50	0,005
812SC89	187650	8-12	8-9	100	4,50	0,005
812SC910	187770	8-12	9-10	100	4,50	0,005
812SC1011	187660	8-12	10-11	100	4,60	0,005
812SC1214	187670	8-12	12-14	100	4,60	0,006
812SC1518	187680	8-12	15-18	100	5,30	0,006
812SC1924	187690	8-12	19-24	100	6,90	0,007
812SC2530	187700	8-12	25-32	100	8,30	0,009









	Obj.č.	A mm	M		Kus		
					kg/NS	Kč	kg
P4 - EPZ							
EBC	170380	≤16	6	100	45	42,10	0,021



	Obj.č.	A mm		Kus		
				kg/NS	Kč	kg
P4 - EPZ						
EBC - 25	172430	≤16	10 x 25	45	42,10	0,021



	Obj.č.	Ø mm		Kus		
				kg/NS	Kč	kg
P1						
TKN M6	386805	M6	140	120	66,10	0,09
TKN 8	389500	9	100	120	74,30	0,09
TKN M8	386810	M8	100	120	29,60	0,09
TKN 10	389510	11	100	250	60,00	0,15
TKN M10	386820	M10	100	250	55,50	0,15
TK 12	389520	13	80	350	99,10	0,17
TK M12	386830	M12	80	350	99,10	0,17



	Obj.č.	Ø mm		Kus		
				kg/NS	Kč	kg
P1						
TKN8 - 5	175830	9	10 x 5	120	83,50	0,181
TKN10 - 5	175840	11	10 x 5	250	89,20	0,174
TKNM6 - 5	175910	M6	10 x 5	120	77,60	0,174

BTK ŠROBOVACÍ PŘÍCHYTKA

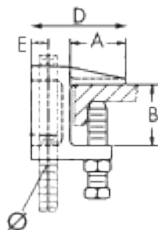
	Obj.č.	Ø	A mm	B mm	D mm	E mm		Kus		
								kg/NS	Kč	kg
P1										
BTK M10	389890	M10	21,4	31,8	48,4	8,7	50	280	115,60	0,17
BTK M12	388890	M12	18,9	31,8	48,4	9,5	50	510	146,20	0,28



HB2 PŘÍCHYTKA

	Obj.č.	A mm		Kus		
				kg/NS	Kč	kg
P1						
HB2	336030	< 24	50	70-250*	223,90	0,30
P3						
HB2-3	336040	< 24	50	70-250*	263,50	10,30

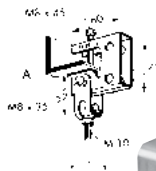



Matice a závitová tyč nejsou součástí dodávky.



HB2-3 má povrchovou úpravu žárovým zinkem



* zatížení závisí na úhlu upevnění

C - PŘÍCHYTKA

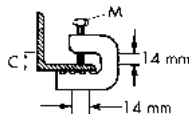
	Obj.č.	C mm	M mm		Kus		
					kg/NS	Kč	kg
P3							
C20	336100	20	6x25	100	110	128,80	0,092
C30	336110	30	8x30	100	110	184,20	0,140
C45	336120	45	8x30	50	110	217,30	0,200

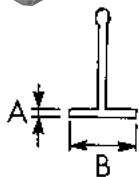





	Obj.č.	Å mm	B mm		Kus		
					kg/NS	Kč	kg
P4 - EPZ							
4G16H	170230	1,5	24-26	100	18	22,00	0,010



4G24H PŘÍCHYTKA

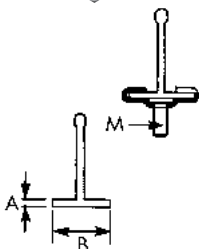

	Obj.č.	Å mm	B mm		Kus		
					kg/NS	Kč	kg
P4 - EPZ							
4G24H	170490	1,5	24-26	100	18	16,50	0,010

4G16M PŘÍCHYTKA



	Obj.č.	A mm	B mm	M mm		Kus		
						kg/NS	Kč	kg
P4 - EPZ								
4G16M7	178590	1,5	24-26	6x7	100	22	29,40	0,014
4G16M11	178600	1,5	24-26	6x11	100	22	30,90	0,015
4G16M16	171900	1,5	24-26	6x16	100	22	33,90	0,015
4G16M25	176880	1,5	24-26	6x25	100	22	37,00	0,015
4G16M38	171890	1,5	24-26	6x38	100	22	39,90	0,017
4G16M51	171870	1,5	24-26	6x51	100	22	43,60	0,021
4G16M76	171880	1,5	24-26	6x76	100	22	47,40	0,022

ŘETÍZKY CHK

Obj.č.	A mm	D mm	T mm	P1	Metr			
					max N	Kč	kg	
CHK22K	385860	9	2,0	28	30 m	400	22,50	0,120
CHK25K	385870	10	2,2	31	30 m	500	13,30	0,130
CHK27K	385880	11	2,5	35	30 m	700	31,10	0,140
CHK30K	385890	12,5	2,8	39	30 m	900	33,50	0,153
CHK32K	385900	14	3,1	41	25 m	1200	37,20	0,165

Všechny řetízky jsou dodávány v kartonech po 30 m (pouze CHK 32 po 25 m)

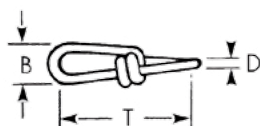
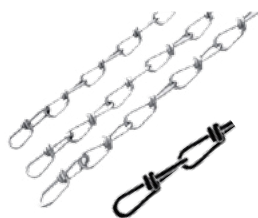

ŘETÍZKY CHN

Obj.č.	A x B mm	C	P1	Metr			
				max N	Kč	kg	
CHN13K	386780	16x8	1,5	30 m	200	33,50	1,10
CHN15K	385910	29x10	2,5	30 m	300	37,20	2,50
CHN17K	385920	32x12	3,0	30 m	400	43,80	3,40

Všechny řetízky jsou dodávány v kartonech po 30 m

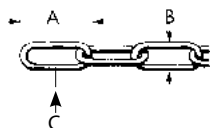
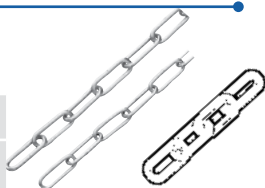

S-HÁK

Obj.č.	B mm	L mm	Ø mm	P1	Kus			
					max N	Kč	kg	
KN30	380050	12,5	16,5	3	100	370	5,50	0,008
KN40	380060	16,0	20,0	4	100	550	6,30	0,009
KN50	380070	20,0	23,0	5	100	950	8,60	0,016

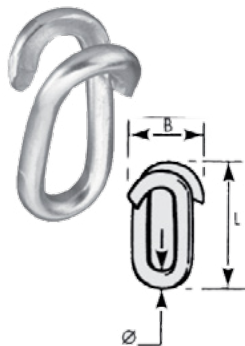

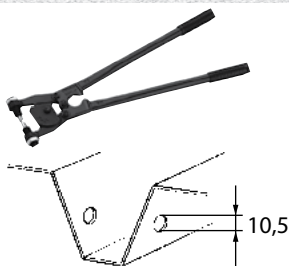

Obj.č.	Kus	Kus	
		Kč	kg
	P1		
TDHP MK2	159441	1	10859,50 2,5
*TDHP MK2 REPAIR	159442	1	2375,10 2,5

* NÁHRADNÍ nože pro tdhp mk2

TDH/TDHM TRAPÉZOVÉ PŘÍCHYTKY

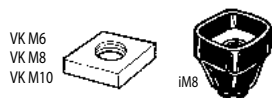
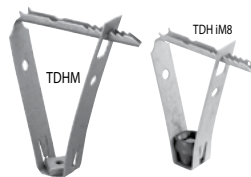
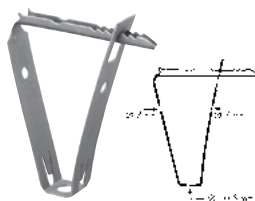

Obj.č.	Kus	Kus		
		kg/NS	Kč	kg
	P4 - EPZ			
TDH	179920	50	60-150 56,40	0,048

Obj.č.	Kus	Kus		
		kg/NS	Kč	kg
	P4 - EPZ			
TDHM6	179930	50	60-150* 67,70	0,058
TDHM8	179940	50	60-150* 67,70	0,058
TDHM10	179950	50	60-150* 67,70	0,058
TDHiM8	179510	50	20 95,50	0,058

* nosnost závisí na síle trapézového plechu

TBHK TRAPÉZOVÁ PŘÍCHYTKA

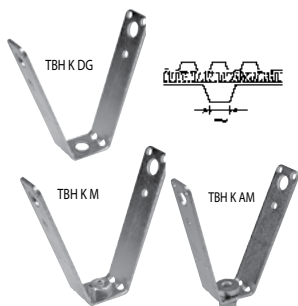

Obj.č.	Kus	Kus		
		kg/NS	Kč	kg
	P1			
TBHK DG 10,5	597581	50	60-150* 20,60	0,100
TBHK M8	597582	50	60-150* 27,50	0,110
TBHK M10	597583	50	60-150* 27,50	0,112
TBHK AM8	597584	50	60-150* 64,50	0,106
TBHK AM10	597585	50	60-150* 65,80	0,112



* nosnost závisí na síle trapézového plechu

NAPÍNÁK NEREZOVÉHO PÁSKU

Obj.č.		Kus	
		Kč	kg
591290	1	5332,50	1,80



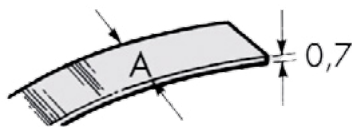

NEREZOVÝ STÁHOVACÍ PÁSEK

	Obj.č.	A mm		Metr	
				Kč	kg
P2					
FEI10	591200	10	50 m	49,90	0,057
FEI12	591210	12,7	50 m	61,40	0,072
FEI16	591220	16	50 m	65,20	0,092
FEI20	591230	20	50 m	80,40	0,114



NEREZOVÝ UZÁVĚR

	Obj.č.	A mm		Metr	
				Kč	kg
P2					
BEI10	591250	10	100	8,90	0,004
BEI12	591260	12,7	100	9,70	0,010
BEI16	591270	16	100	11,00	0,012
BEI20	591280	20	100	11,60	0,017

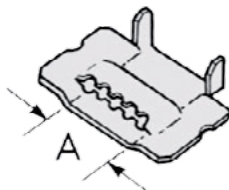

CADDY

ERICO

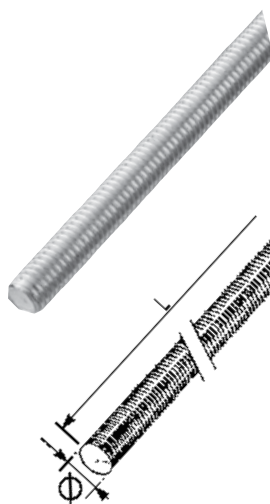

Obj.č.	Ø mm	L mm	Kus	Kus		
				Kč	kg	
P1						
1TFZ6	592570	M6	1	100	25,00	0,18
2TFZ6	592580	M6	2	50	52,00	0,36
3TFZ6	592650	M6	3	50	75,90	0,54
P1						
1TFZ8	592590	M8	1	50	40,00	0,30
2TFZ8	592600	M8	2	25	75,90	0,60
3TFZ8	592660	M8	3	25	123,60	0,90
P1						
1TFZ10	592610	M10	1	25	63,00	0,44
2TFZ10	592620	M10	2	25	123,60	1,32
3TFZ10	592670	M10	3	25	183,30	1,32
P1						
1TFZ12	592630	M12	1	25	81,10	0,64
2TFZ12	592640	M12	2	20	152,40	1,28
3TFZ12	592680	M12	3	20	242,60	1,92

NATLOUKACÍ HMOŽDINKA NPN



Obj.č.	Ø mm	Kus	Kus		
			Kč	kg	
P1+P5					
NPN530	570790	5x30	100	1,80	0,003
NPN640	570800	6x40	100	2,50	0,004
NPN660	570810	6x60	100	3,10	0,006
NPN680	570820	6x80	100	3,90	0,008
NPN860	570830	8x60	100	4,70	0,010
NPN880	570840	8x80	100	5,50	0,013
NPN8100	570850	8x100	100	5,60	0,016
NPN8120	570860	8x120	100	10,90	0,018